

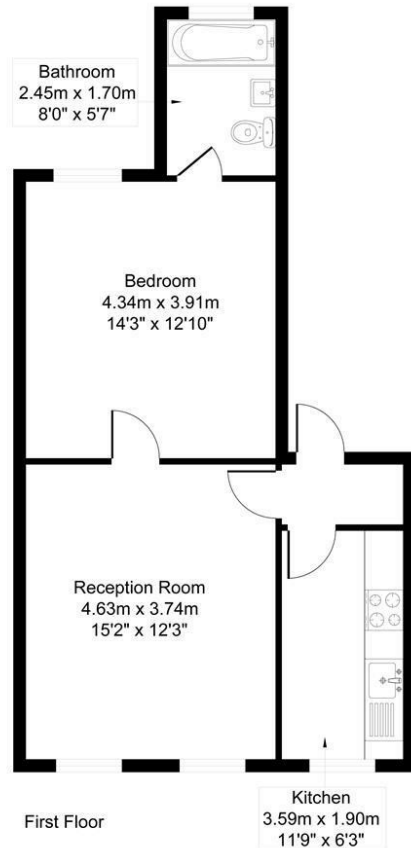

£1,675  
Endymion Road  
Finsbury Park, N4 1EQ

EPC RATING: COUNCIL TAX BAND: B

## 42 Endymion Road N4 1EQ



Approximate Gross Internal Area = 49.05 sq m / 527.96 sq ft  
Illustration for identification purposes only, measurements are approximate, not to scale



| Energy Efficiency Rating                    |  | Current                 | Potential |
|---|--|-------------------------|-----------|
| Very energy efficient - lower running costs |  |                         |           |
| (92 plus) <b>A</b>                          |  |                         |           |
| (81-91) <b>B</b>                            |  |                         |           |
| (69-80) <b>C</b>                            |  |                         |           |
| (55-68) <b>D</b>                            |  |                         |           |
| (39-54) <b>E</b>                            |  |                         |           |
| (21-38) <b>F</b>                            |  |                         |           |
| (1-20) <b>G</b>                             |  |                         |           |
| Not energy efficient - higher running costs |  |                         |           |
| <b>England &amp; Wales</b>                  |  | EU Directive 2002/91/EC |           |



Agents Note: Whilst every care has been taken to prepare these particulars, they are for guidance purposes only. All measurements are approximate and are for general guidance purposes only and whilst every care has been taken to ensure their accuracy, they should not be relied upon and potential buyers/tenants are advised to recheck the measurements

**Paul Simon**  
Estate agents

**OFFICE ADDRESS**  
786-788 Green Lanes  
London  
N21 3RE

**OFFICE DETAILS**  
0208 800 1155  
management@paul-simon.co.uk